

City of Worthington Water System December 2005

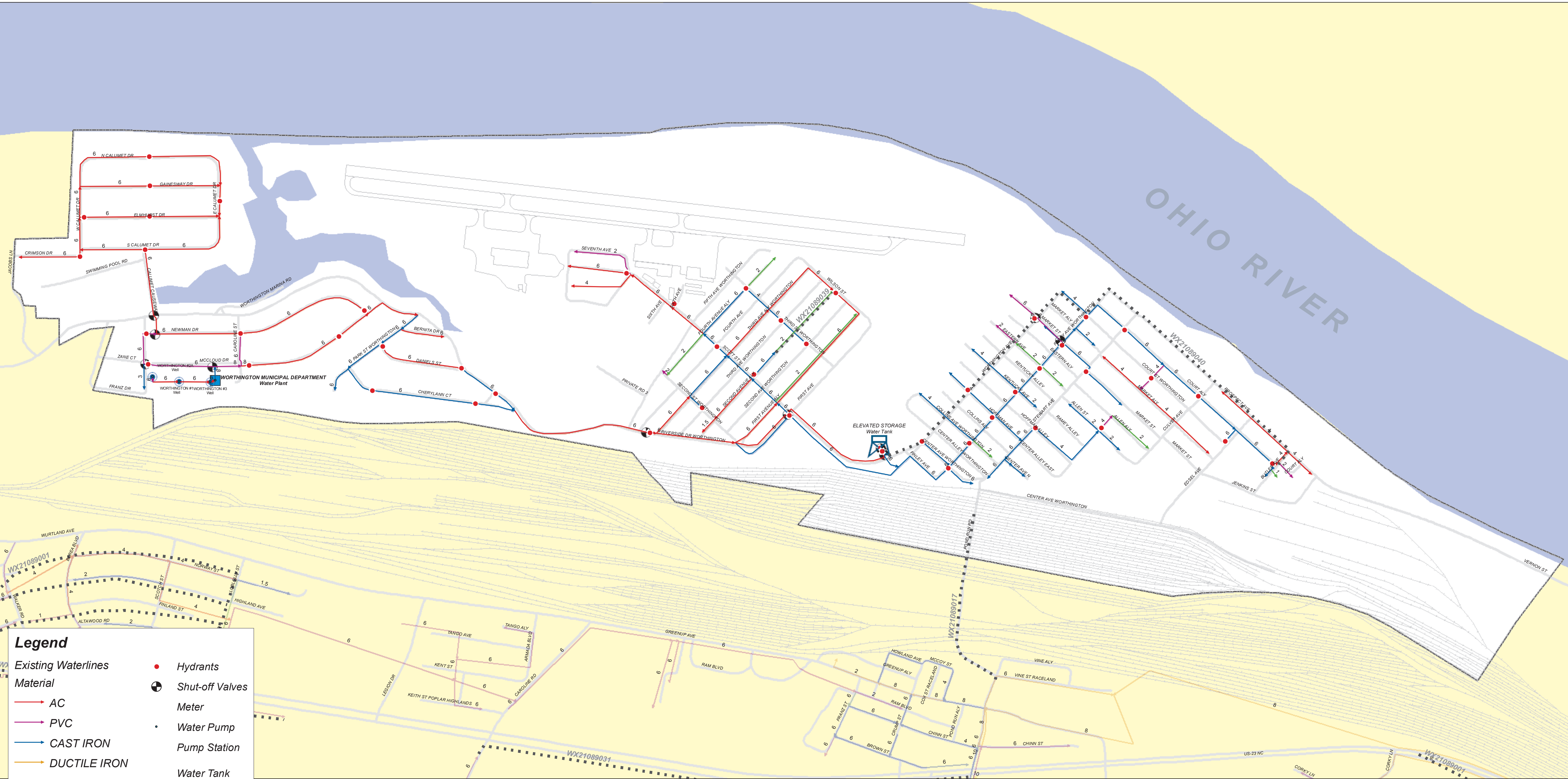

Legend

Existing Waterlines	● Hydrants
Material	⊕ Shut-off Valves
→ AC	Meter
→ PVC	• Water Pump
→ CAST IRON	Pump Station
→ DUCTILE IRON	Water Tank
→ POLYETHYLENE	Well Source
→ OTHER	Water Plant
--- Waterline Projects	Railroad
	Roads



To the best of my knowledge, this planning map and associated data are an accurate current representation of the City of Worthington water system.

Authorized Representative _____ Date _____

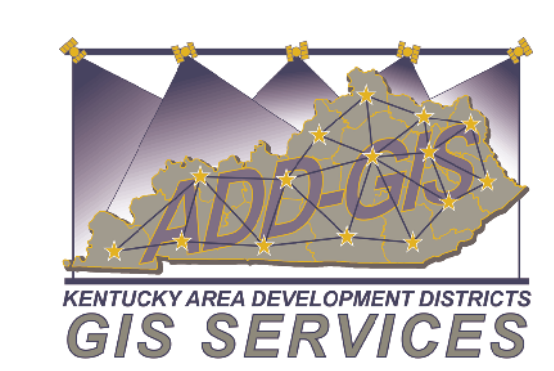

1 inch equals 400 feet

Limitation of Liability: The information contained on this map is to be used for planning purposes only. The FIVCO Area Development District provides no warranties of any kind for the accuracy or use of this information outside the context of use for planning purposes.

